

Teladoc Health™ Viewpoint® Tablet Stand Set-up Guide

P/N: MA-20116-003

© Copyright, 2021 Teladoc Health™

Release: 42



Viewpoint Tablet Stand Set-up Guide

The Viewpoint Tablet Stand requires minor assembly to get up and running.

1. Unpack the tablet stand and place the 2 main components on a flat working surface.
2. Insert the pole into the base, with the handle on the narrow side of the base.

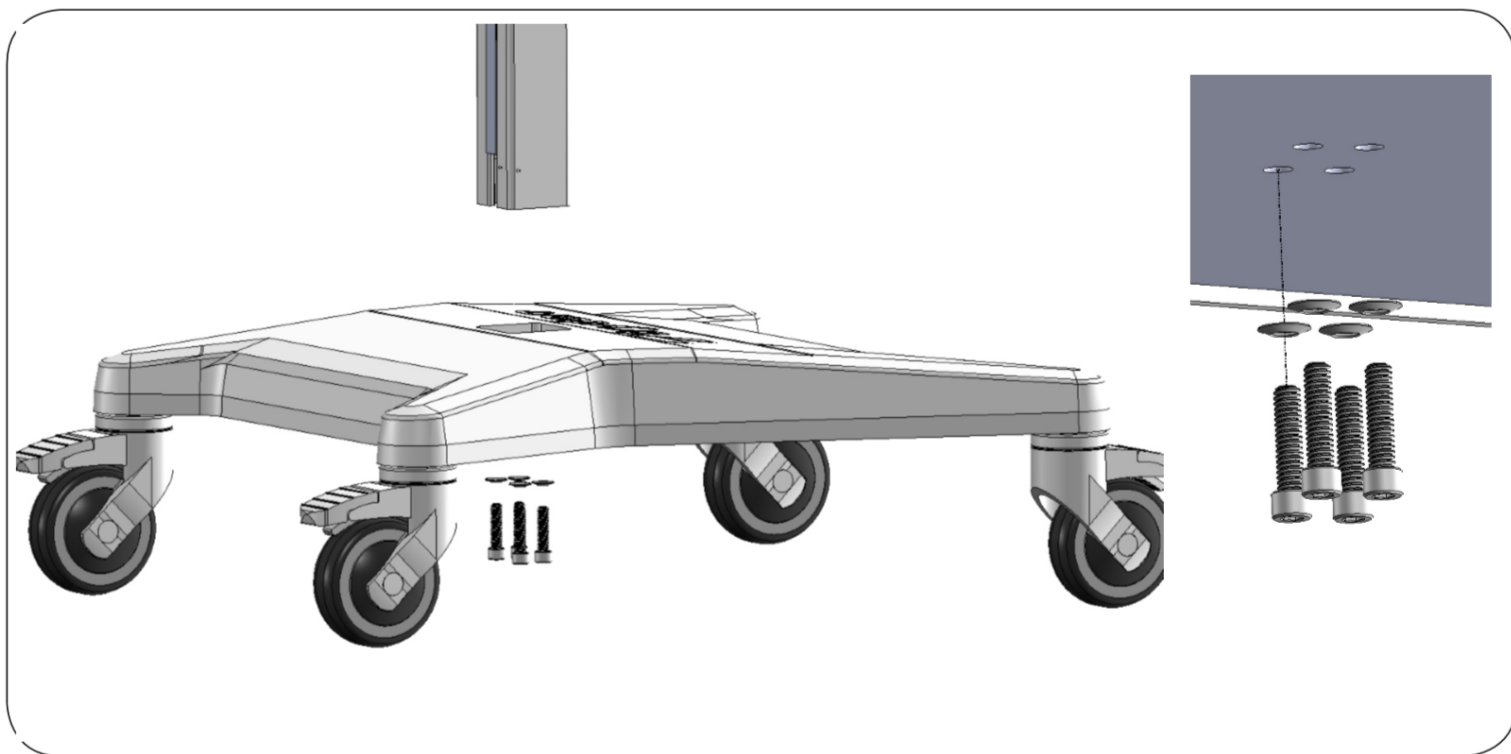

3. Secure the pole using the provided screws and washers, using the included 3/16-inch hex L-key (Allen wrench). Tighten.

4. Stand up the assembly.

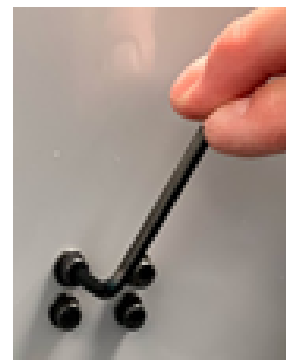

Insert the tablet

1. Unpack the tablet.

NOTE: Ensure that the head is oriented with the head right side up to install the tablet (Tryten label right side up).

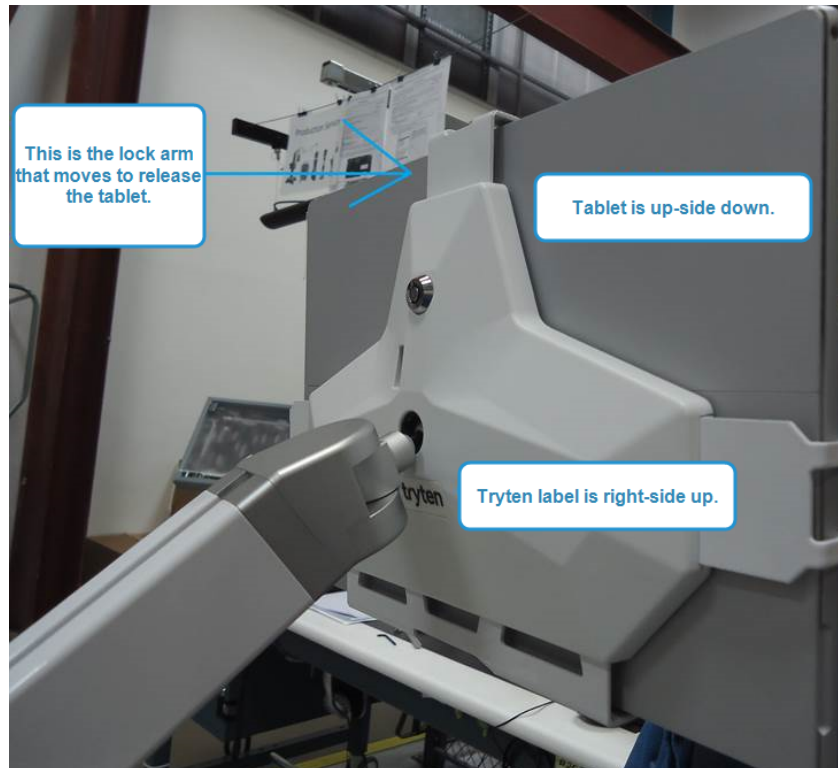

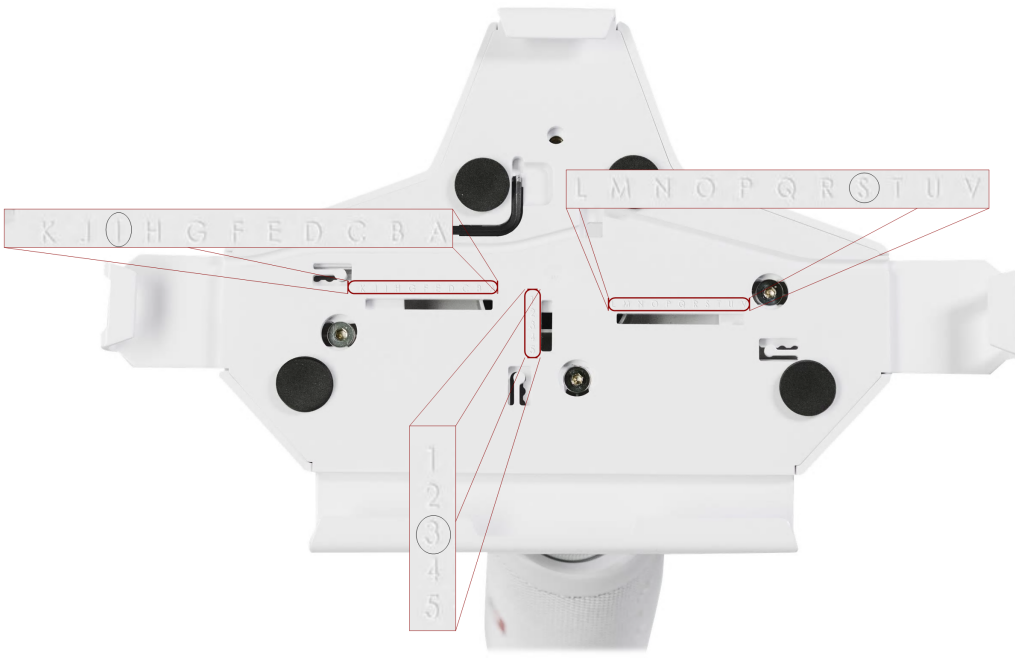

For the Windows Viewpoint Tablet, using a Microsoft Surface Pro Tablet, verify the following settings on the tablet gripping sliders:

- Vertical grip, #3.
 - Horizontal grips, “I” and “S”.
2. Unlock the locking top gripping slider.
 3. Orient the tablet upside down (with the camera at the “bottom”) and gently slide the tablet into the head.
 4. Lock the tablet in place by reinstalling the top gripping slider and then pushing in the locking-pin.

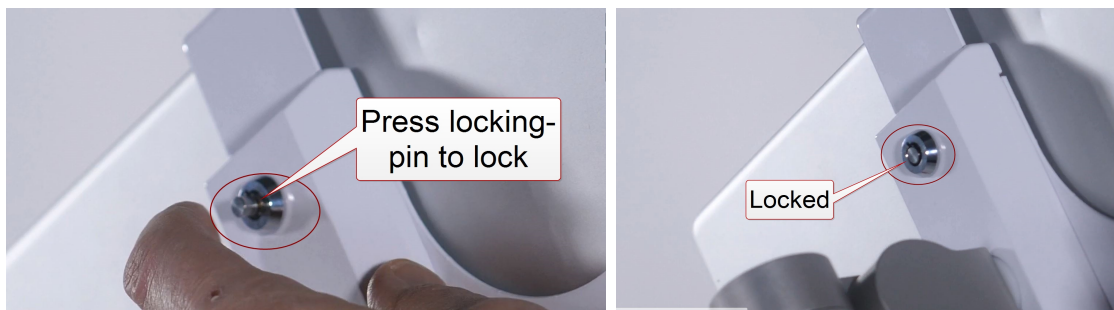

5. Ensure that the tablet is secure and that the top gripping slider is locked in place.
6. Rotate the tablet so that it is upright (camera on top), and Tryten label upside down.
7. Plug in the stand.

NOTE: For power-on procedure, refer to Viewpoint Tablet guides.

Tablet removal:

WARNING: Ensure that the head is oriented with the head right side up to remove the tablet (Tryten label right side up). If the head is in the incorrect position when releasing the tablet, the tablet may fall to the floor and get damaged.

1. Rotate the tablet so that it is upside down (camera on bottom), and Tryten label right side-up.
2. Ensure that the top gripping slider is upright.
3. Unlock top gripping slider, sliding it upward.
4. Gently slide the tablet up and out.
 - Quick Start, MA-20029, included.
 - Manual, MA-20058, available from your InTouch representative or at <https://intouchhealth.com/manuals/>

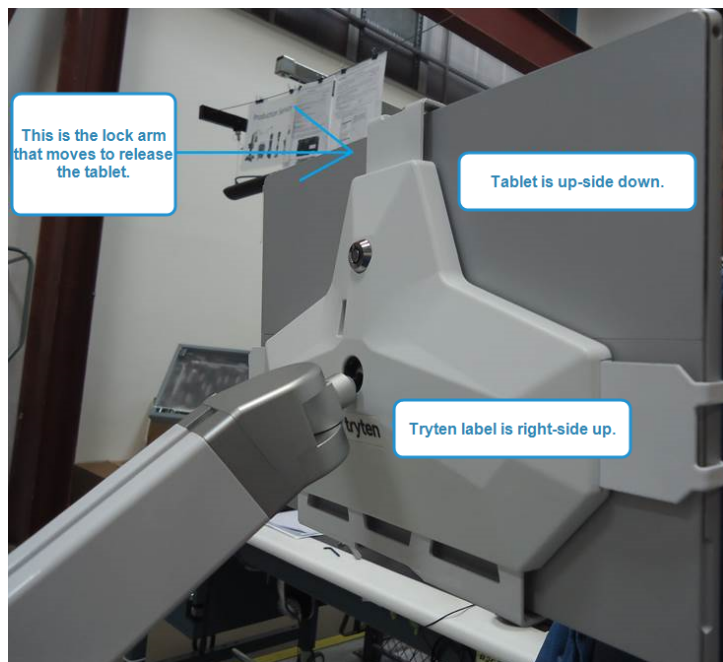

NOTE: For any questions or concerns regarding the Viewpoint Tablet Stand, please contact your sales representative.

Contact Information

24/7 Live Technical Support

[+1 \(877\) 484-9119](tel:+18774849119)

24/7 Live Remote Technical Support & Live Chat

<https://intouchhealth.com/contact-us/>

Email Support

ITHSupport@intouchhealth.com

Website

www.InTouchHealth.com

Teladoc Health User Manuals

<https://intouchhealth.com/manuals/>

Sales & Product Demos

(805) 562-8686

InTouch Technologies, Inc.

7402 Hollister Avenue Goleta, CA 93117

Ph: +1.805.562.8686 • Fax: +1.805.562.8663

www.intouchhealth.com

©2021 Teladoc Health, Inc.

InTouch Health and InTouch Technologies are now a Teladoc Health company, and InTouch Health is a registered trademark of Teladoc Health.

LEARN MORE

TeladocHealth.com | engage@teladochealth.com



About Teladoc Health

Teladoc Health is the global virtual care leader, helping millions of people resolve their healthcare needs with confidence. Together with our clients and partners, we are continually modernizing the healthcare experience and making high-quality healthcare a reality for more people and organizations around the world.